

SURVEYOR'S RECORD

Section 34

Township 106

Range 40

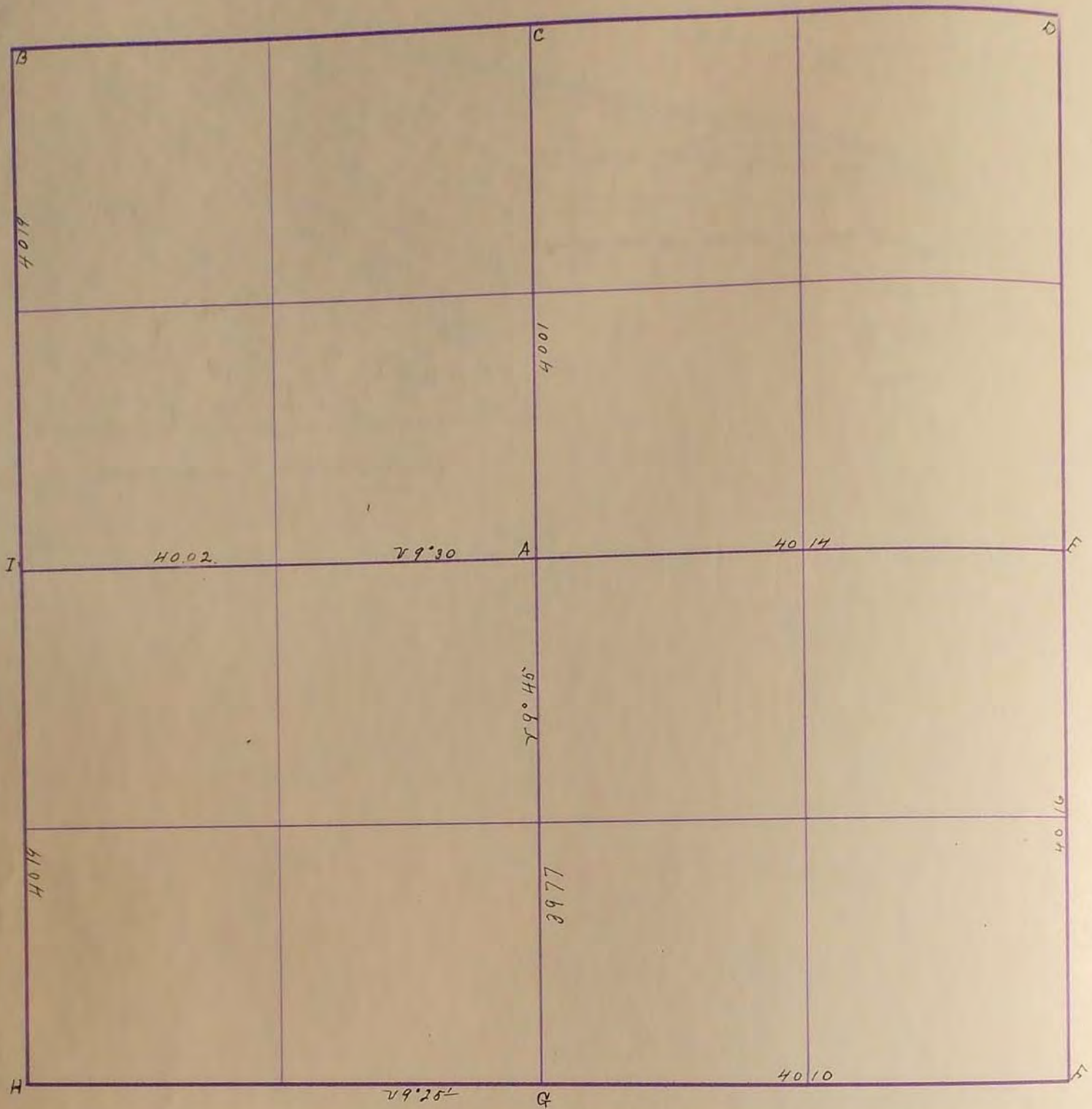

Apr. 27-1899

- A. cedar fence post
- B. Gov. mound + stake
- C. Stone in grade
- D.
- E. Gov. mound Pts and stake
- F.
- G. Stone in grade
- H. Stone + stake "Oak"
- I. Oak stake in grade

J. W. Hoelstenecroft

B. Located 1/2" Steel Rod 36" long at sod grade with clay brick around pin. R.P. N&C. Blazed maple tree 2/5 86.33; R.P. N&C. Cor. post N/W. 40.72; R.P. N&C. Gate post West 51.73

SURVEY No. 33

Section 311

Town 106

Range 40

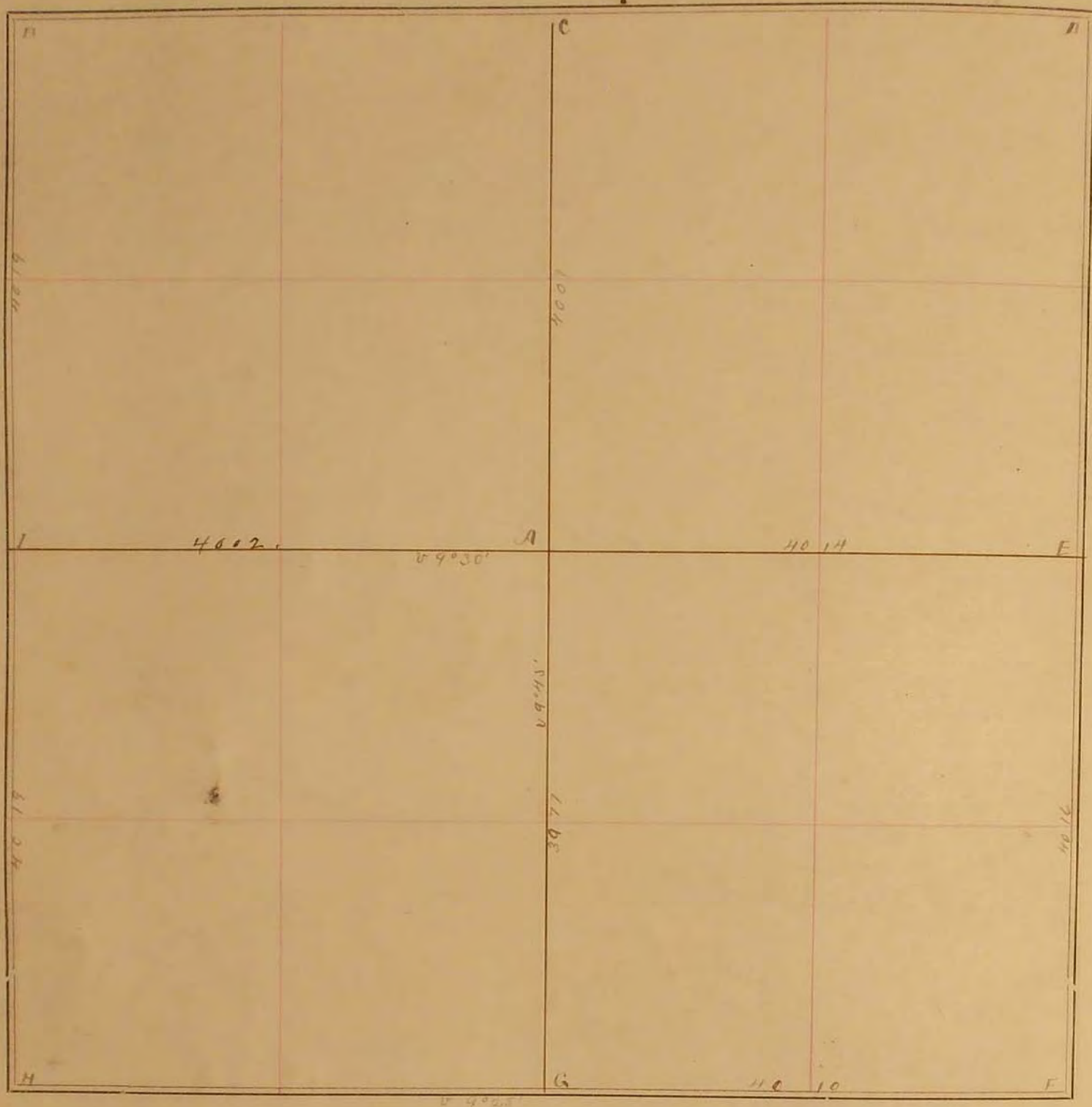

FIELD NOTES.

April 27, 1899,

- A. Cedar fence post.
- B. Gov. Mound + stake.
- C. Stone in grade.
- D.
- E. Gov. Mound, Pits + Stake.
- F.
- G. Stone in grade.
- H. Stone + Stake, "Oak"
- I. Oak Stake in grade.

J. W. Woodlin